

# TOSHIBA

**e-STUDIO330AC**

**e-STUDIO400AC**

## Product brochure

---

- Toshiba's A4 colour systems deliver outstanding document output at a speed of up to 40 pages per minute.
- Large, fully customisable user interfaces enable you to boost efficiency and tailor workflows to fit your needs.
- Both models easily integrate into the A3 e-BRIDGE Next line. They give you all the convenience of Toshiba colour systems, fit seamlessly into modern business environments and support cloud and mobile printing.



**TOGETHER  
INFORMATION**

## Connect. Integrate. Simplify. And more.

### Advanced functionality, ease of use and peace of mind.

Every business is unique. That's why Toshiba offers not only the latest technology, but also outstanding adaptability. Our customisable solutions can be precisely tailored to meet your needs. With Toshiba colour systems you can simplify complex tasks and maximise productivity. They let you handle large numbers of documents from diverse sources – efficiently and securely.

Toshiba's latest series delivers on our promise of Together Information – our commitment to working with clients to provide tailored, cost-effective solutions that meet all your print, document management and content needs. At the same time, we want to support you in fulfilling your energy-efficiency and sustainability objectives.

### Superior document workflows, outstanding colour output.

No reason to compromise on colour: Toshiba's e-STUDIO400Ac series gives you excellent workflow efficiency and top-notch image quality combined. With advanced features, the multifunctional systems cover even the most demanding needs.

- Advanced Toshiba e-BRIDGE Next controller technology for easy integration into IT environments and customised document workflows.
- Impeccable, high-quality output with a resolution of up to 1,200 x 1,200 dpi.
- Colour consistency in small and high-volume print jobs.

## Simple. Smart. And up-to-date.

Toshiba has designed the e-STUDIO400Ac series to ensure an easy and pleasant user experience. Thanks to the 26 cm (10.1"), tablet-style multi-touchscreen, the systems are intuitively operable.

The touchscreens are also fully customisable for increased productivity and efficiency. That means complicated multi-step processes can be turned into one-touch functions and will help streamline your document workflows.

### Unique user experience

The large and fully customisable user interface makes the multifunctional printer (MFP) intuitive to use. Simply swipe through the menu and select the feature or function you need. You can then modify the screen to suit your individual preferences.



# Advanced technology for more efficiency.

To succeed in today's business world, you need fast, flexible and easy access to information and data – anytime, anywhere. But you also need ironclad security and excellent energy efficiency. The e-STUDIO400Ac series has it all covered.

Profit from: Flexible integration with third-party solutions and applications, an embedded web browser and support of cloud and mobile printing. And these are just some of the features that will boost your efficiency and productivity.

Since your company has its own individual needs, processes and preferences for storing and sharing data, we have also designed the colour systems for easy customisation using apps<sup>1)</sup>. Whether you want to connect to cloud services or local applications – or have other wishes – the cost-effective and simple-to-operate e-STUDIO400Ac series has the answers.

## Cloud solution apps

- e-BRIDGE Plus for Box™
- e-BRIDGE Plus for Dropbox®
- e-BRIDGE Plus for Google Drive™
- e-BRIDGE Plus for G suite™ Google Drive™
- e-BRIDGE Plus for Gmail™
- e-BRIDGE Plus for OneDrive®
- e-BRIDGE Plus for OneDrive® for Business<sup>2)</sup>
- e-BRIDGE Plus for SharePoint® Online<sup>2)</sup>
- e-BRIDGE Plus for Exchange Online<sup>2)</sup>

## Workflow solution apps

- e-BRIDGE Plus for Barcode Scan
- e-BRIDGE Plus for USB Storage
- e-BRIDGE Plus for Green Information
- e-BRIDGE Plus for Zone OCR

To ensure you a perfect fit, our team of software developers can even create customised apps for you.

<sup>1)</sup> Availability of apps may vary from country to country.

<sup>2)</sup> Embedded app for Microsoft 365.

## Mobile Printing

You can easily connect to our systems with your mobile devices via AirPrint, Google Cloud Print or the Mopria Print Service. By adding the optional WiFi module you can access even more mobile print and scan features.

## State-of-the-art security

Of course, all of the advanced features of the e-STUDIO400Ac series are designed with your data security as a top priority. In addition, we offer a large range of built-in and optional features to protect your business data:

- The self-encrypting Toshiba Secure HDD provides top-level security and makes unauthorised access to the data virtually impossible.
- Card readers not only provide an extra layer of security, but also give direct access to the user's print jobs. We offer a large selection of card readers with different features to match your data security needs.
- By adding optional security functions, the systems can be made conformant with HCD-PP v1.0 and Common Criteria certified.



## Compact. Cool. And fully customisable.

Don't be fooled by the small footprint of the e-STUDIO400Ac series: the systems are packed with industry-leading technology and innovations. They are systematically engineered to help workgroups connect, integrate and simplify processes.

**RGB Colour Substitution** keeps colours accurate when using office applications. Your documents appear exactly as you want them to.

**Multi-Station Print Solution** lets you to send print jobs from your desktop and retrieve them at up to 50 different MFPs. All you need to do is identify yourself at the device, e.g. by simply swiping your badge.

**Embedded Optical Character Recognition (OCR)** and e-BRIDGE Plus for Zone OCR. OCR simplifies the creation of searchable PDFs and editable document formats such as Microsoft Word. The e-BRIDGE Plus for Zone OCR app increases your productivity while digitising paper documents. Up to three zones of texts, numbers and barcodes are recognised. This information can then be used to automatically sort and/or serve as folder and file names.

**Scan and Fax Preview** enables you to review, rotate and modify your scanned documents or incoming faxes before saving or printing them.

**Print from and Scan to USB** is great for working with your documents when on the go. For quick and easy printouts automatically scaled to the available paper size if requested.

**E-mail Direct Printing** can automatically print attached documents from e-mails sent to the MFP.

**Barcode Printing** gives you the option of sending print data from your ERP system directly to the MFP. The barcode sequence is automatically processed and printed without the need of additional middleware.



# Configuration

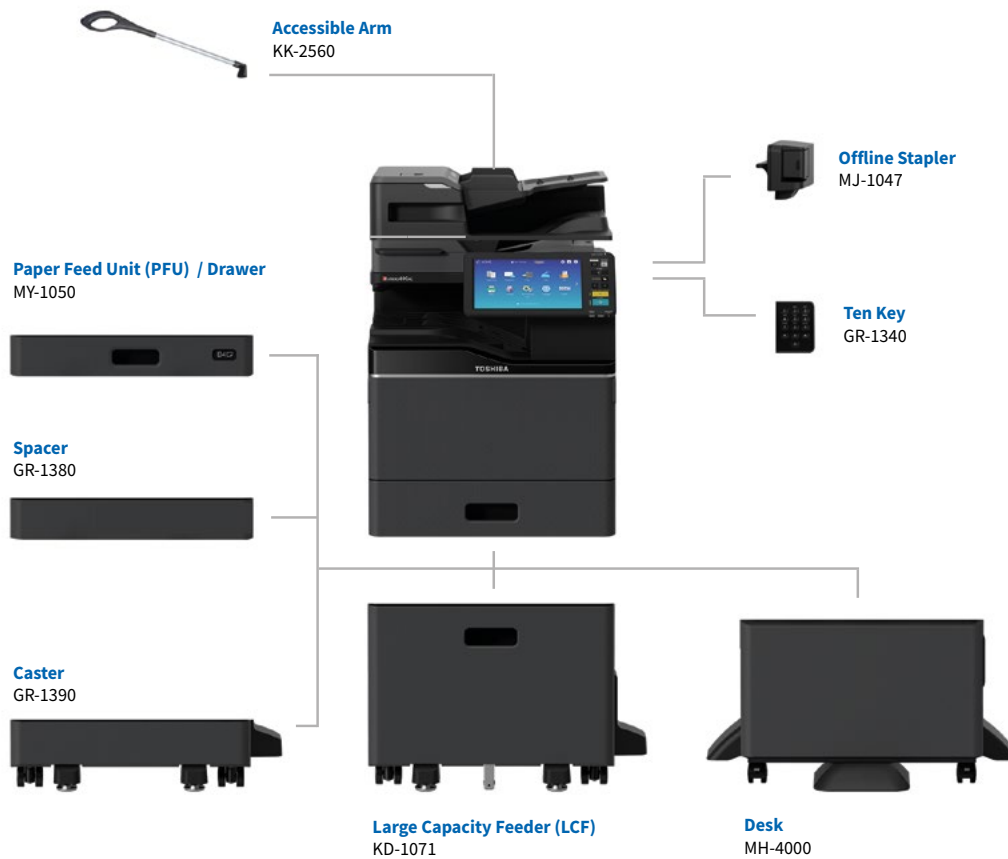

## Highlights

### Dual Scan Document Feeder

It holds an amazing 100 originals and delivers an impressive 116 images per minute (ipm) and it scans both sides of the page in a single pass.

### Environmental protection

Protecting the environment is embedded in our corporate philosophy. We ensure that our products comply with the highest environmental standards. Top-of-class TEC values and a low-power sleep mode are just two examples of how we can help you protect valuable resources and reduce your CO<sub>2</sub> footprint.

With the e-BRIDGE Plus for Green Information app you can see your environmental contribution directly on the screen of the MFP. It provides simple graphs and helps promote more effective paper usage.

# Specifications

## General

<b>Print &amp; Copy Speed</b>	33/40 ppm
<b>Warm-up Time</b>	~ 18 seconds from low power mode
<b>Paper Size &amp; Weight</b>	Cassette : A5-A4, 60-256 g/m <sup>2</sup> Bypass: A4-98 x 148 mm, 52-256 g/m <sup>2</sup> , Banner paper (up to 215.5 x 1,321 mm, 90-163 g/m <sup>2</sup> )
<b>Paper Capacity</b>	Cassettes: 550 sheets, Bypass: 1x 100 sheets Max. 3,200 sheets
<b>Inner Output Tray</b>	250-sheet capacity
<b>Automatic Duplex</b>	A5-A4, 60-256 g/m <sup>2</sup>
<b>Controller Type</b>	Toshiba e-BRIDGE Next
<b>Control Panel</b>	26 cm (10.1") Multi-Touch Colour Panel
<b>Memory</b>	Toshiba Secure HDD 320 GB <sup>3)</sup> , 4 GB RAM
<b>Interface</b>	10Base-T/100Base-TX/1000Base-T, High Speed USB 2.0, WLAN <sup>1)</sup> , Bluetooth <sup>1)</sup> , Wi-Fi Direct <sup>1)</sup>
<b>Dimensions &amp; Weight</b>	520 x 540 x 634 mm (W x D x H), ~ 53 kg

## Print

<b>Resolution</b>	600 x 600 dpi, 3 bit, 1,200 x 1,200 dpi, 1 bit with PostScript driver only
<b>Page Description Language</b>	PCL5e, PCL5c, PCL6 (PCL XL), XPS, PDF and PostScript 3 compatible
<b>Supported Systems</b>	Windows 10/8.1, Windows Server 2019 (64 bit)/Server 2016/Server 2012 R2/Server 2012, Mac OS X 10.7.5-10.15, Linux/Unix, Citrix, Novell SLES, SAP, AS/400
<b>Network Protocols</b>	TCP/IP (IPv4/IPv6), IPX/SPX, EtherTalk, NetBios over TCP/ IP
<b>Colour Modes</b>	Auto-Colour (ACS), Colour, Twin Colour, Monochrome
<b>Colour Settings</b>	ICC profile colour management, RGB substitution, Brightness, Saturation, Contrast, Colour Balance
<b>Mobile Printing</b>	e-BRIDGE Print & Capture, AirPrint, Mopria Print Service, Google Cloud Print
<b>Print Functions</b>	Universal Printer Driver, Driver Templates, Driver plug-ins <sup>1)</sup> , Print from USB, Hold print, Tandem printing, E-mail direct printing

## Scan

<b>Resolution</b>	Max. 600 x 600 dpi
<b>Scan Speed</b>	Dual Scan Document Feeder (DSDF): up to 80 ipm in colour and 116 ipm in monochrome (300 dpi/duplex)
<b>Scan Modes</b>	Auto-Colour (ACS), Colour, Greyscale, Monochrome
<b>File Formats</b>	JPEG, Multi/Single Page TIFF/XPS/PDF, Secure PDF, Slim PDF, PDF/A, PDF/A-2, Searchable PDF <sup>1)</sup> (and other formats like DOCX, XLSX) <sup>1)</sup>
<b>Scan Functions</b>	WS Scan, Scan to USB, Scan to E-Mail, Scan to File (SMB, FTP, FTPS, IPX/SPX, Local), Meta Scan <sup>1)</sup> , OCR Scan <sup>1)</sup> , Scan to Box (e-Filing), WIA, TWAIN

## Copy

<b>Resolution</b>	Scan: 600 x 600 dpi monochrome, 300 x 600 dpi colour Print: 600 x 600 dpi, 3 bit, equiv. 2,400 x 600 dpi with smoothing (monochrome only)
<b>First Copy Output Time</b>	Colour: ~ 7.2/6.3 seconds Monochrome: ~ 5.7/5.1 seconds
<b>Zoom</b>	Platen: 25-400%, DSDF: 25-200%
<b>Copy Modes</b>	Text, Text/Photo, Photo, Printed Image, Map, Image Smoothing
<b>Colour Modes</b>	Auto-Colour (ACS), Full Colour, Twin Colour, Mono Colour, Monochrome
<b>Colour Settings</b>	Hue, Saturation, Colour Balance, RGB adjustment, 5 one-touch modes
<b>Copy Functions</b>	Electronic Sort, ID Card Copy, Edge Erase, 2-in-1 / 4-in-1 mode

## Fax<sup>1)</sup>

<b>Communication</b>	Super G3, Internet Fax T.37
<b>Transmission Speed</b>	~ 3 seconds per page
<b>Compression</b>	JBIG, MMR, MR, MH
<b>Fax Memory</b>	1 GB Transmission/Reception
<b>Network-Fax</b>	Driver for Windows 10/8.1 (32/64 bit), Windows Server 2019/Server 2016/Server 2012 R2/Server 2012
<b>Incoming Fax Routing</b>	To shared folders (SMB, FTP), E-Mail, e-Filing

## System & Security

<b>Device Management</b>	Top Access for remote administration and configuration
<b>System Features</b>	e-Filing document server for secure storage, Document distribution and Print-on-Demand (1 public box, 200 user boxes), 12,060 one-touch templates for storage of personalised settings or workflows, Scan/Fax Preview, Rip-while-Print, e-BRIDGE Open Platform, Embedded Web Browser, Job Skip, PCL Barcode printing, e-BRIDGE Plus embedded apps
<b>Accounting &amp; Security</b>	Role Based Access, LDAP support, 1,000 department & 10,000 user codes, Card Reader <sup>1)</sup> , Private print, Standard data encryption with Toshiba Secure HDD, Data Overwrite Enabler <sup>1)</sup> , IP and MAC address filter, Port filter, Support of SSL and IPsec <sup>1)</sup> protocols, IEEE802.1x support, CC certified (ISO/IEC15408) with HCD-PP v1.0 <sup>1)</sup> , Scan to Secure PDF, Pull-printing <sup>1)</sup>

## Options

<b>PAPER FEED UNIT (PFU)</b>	1x 550-sheet capacity, A5-A4, 60-256 g/m <sup>2</sup> , 520 x 540 x 147 mm (W x D x H), ~7.5 kg
<b>LARGE CAPACITY FEEDER (LCF)</b>	1x 2,000-sheet capacity, A4, 60-256 g/m <sup>2</sup> , 605 x 578 x 427 mm, ~29 kg
<b>DESK</b>	766 x 742 x 402 mm (W x D x H), ~15.0 kg
<b>SPACER</b>	520 x 540 x 132 mm (W x D x H), ~5.2 kg
<b>CASTER</b>	605 x 578 x 164 mm (W x D x H), ~12 kg
<b>OFFLINE STAPLER</b>	
<b>PANEL TEN-KEY OPTION</b>	
<b>HARD DISK DRIVE 320 GB<sup>2)</sup></b>	FIPS 140-2 Standard
<b>FAX BOARD</b>	
<b>WIRELESS LAN/BLUETOOTH MODULE</b>	(incl. Wi-Fi Direct)
<b>e-BRIDGE ID GATE</b>	
<b>ACCESSIBLE ARM</b>	

## Licences

**EMBEDDED OCR**  
**MULTI STATION PRINT**  
**IP FAX**  
**DATA OVERWRITE ENABLER**  
**IPsec ENABLER**  
**HARD COPY SECURITY KIT**  
**MONOTYPE FONT**  
**UNICODE FONT ENABLER**  
**META SCAN ENABLER**



<sup>1)</sup> Optional.

<sup>2)</sup> 1 GB = 1 billion bytes; the actual formatted capacity is less. Available capacity will also be less if software applications are pre-installed.

## About Toshiba Tec

Toshiba Tec Germany Imaging Systems GmbH is part of the globally operating Toshiba Tec Corporation, active in various high-tech industrial sectors.

Toshiba Tec Corporation is a leading provider of information technology, operating across multiple industries - ranging from retail, education and business services to hospitality and manufacturing. With headquarters in Japan and over 80 subsidiaries worldwide, Toshiba Tec Corporation helps organisations transform the way they create, record, share, manage and display information.

For more information please contact us:

### Toshiba Tec Germany Imaging Systems GmbH

Carl-Schurz-Str. 7  
41460 Neuss  
Germany

#### Telephone

+49 2131-1245-0

#### Fax

+49 2131-1245-402

#### Website

[www.toshibatec.eu](http://www.toshibatec.eu)



**Together Information is Toshiba's vision for how people and organisations create, record, share, manage and display ideas and data.**

**It is based on our belief that the most successful organisations are those that communicate information in the most efficient way.**

**We make that possible through an integrated portfolio of industry-specific solutions, all of which reflect Toshiba's commitment to the future of the planet.**

